

ALSO SEE DETAIL 14B  
FOR ISOMETRIC VIEW

STANDARD FLUID  
APPLIED ROOF  
SYSTEM

PLAN

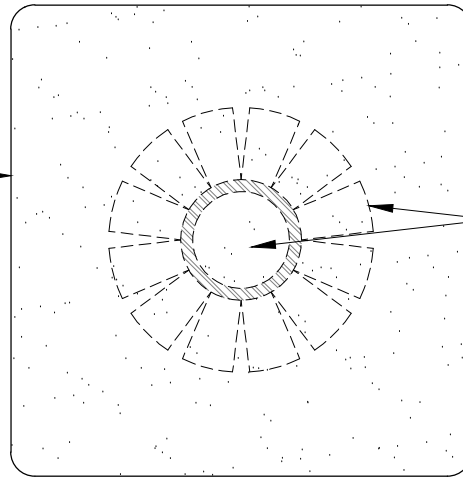

1. REINFORCING  
FABRIC PIPE WRAP

2. 12"X12" REINF.  
FABRIC OVER PIPE  
WRAP

NOTES:

1. THIS DETAIL IS A TYPICAL PENETRATION DETAIL APPLICABLE FOR ALL COLD PIPE PENETRATIONS. FOR HOT PIPE PENETRATIONS CONTACT THE MANUFACTURER FOR REQUIREMENTS.
2. FOR PIPE PENETRATIONS THAT EXCEED 18" ABOVE THE ROOF SURFACE A STORM COLLAR SHALL BE USED WITH A DRAW BAND AND CAULKING. THE ROOF COATING SHALL EXTEND 8" (MIN) UP PENETRATION SURFACE.
3. FLUID APPLIED RESTORATION COATING SYSTEM - BASE COAT, REINFORCED FABRIC, BASE COAT 2, AND FINISH COAT COMPONENTS.
4. PRIMING - REFER TO TROPICAL ROOFING PRODUCTS SPECIFICATIONS FOR DECK PRIMING REQUIREMENTS.

NOTE: FOR SPECIFIC PRODUCT RECOMMENDATION REFER TO THE APPROPRIATE FLUID APPLIED SYSTEM GUIDE SPECIFICATIONS AT [WWW.TROPICALROOFINGPRODUCTS.COM](http://WWW.TROPICALROOFINGPRODUCTS.COM)

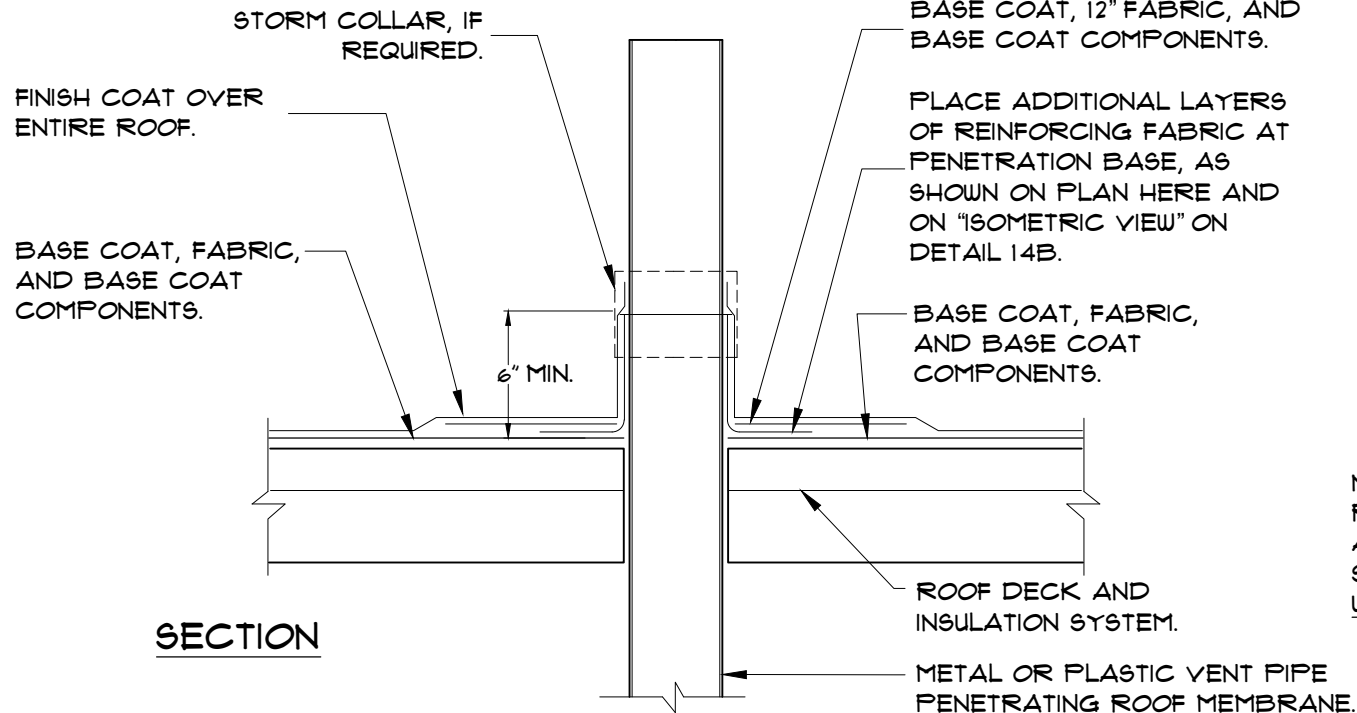

SECTION

**FLUID APPLIED RESTORATION COATING SYSTEM**

**TYPICAL VENT PIPE FLASHING DETAIL**

DATE :  
**12-13-16**

DETAIL NO :  
**14a**

