

NOTE: STRUCTURAL CONCRETE MUST BE CURED AT LEAST 28 DAYS. REFER TO CONCRETE MANUFACTURER CURING TIME.

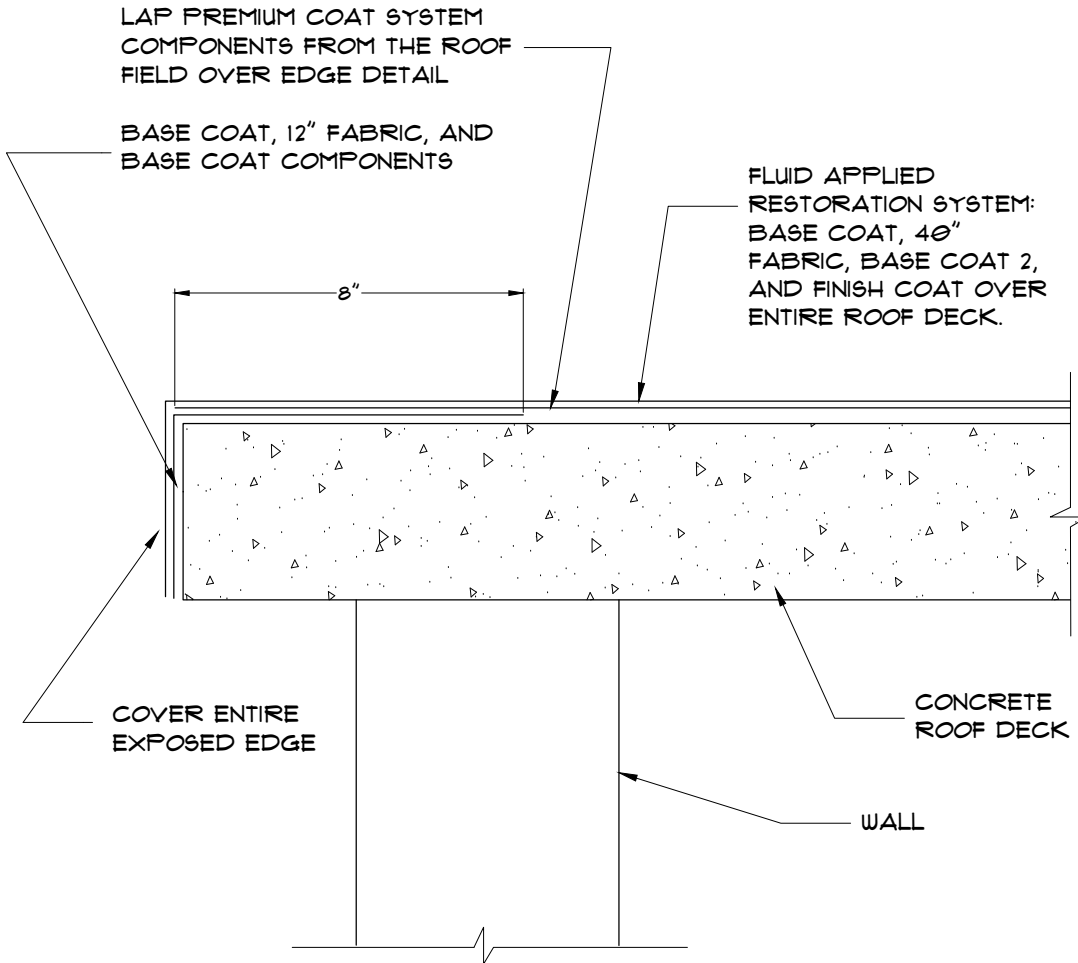

NOTES:

1. ALL FLASHING SHALL BE DESIGNED FOR THE APPLICABLE ROOF CONDITIONS. METAL THICKNESS, FASTENERS, AND LAPPING SHALL BE AS SPECIFIED BY THE ROOF DESIGNER.
2. REFER TO TROPICAL ROOFING PRODUCTS SPECIFICATIONS FOR SPECIFIC EXECUTION REQUIREMENTS.
3. FLUID APPLIED RESTORATION SYSTEM – BASE COAT, REINFORCED FABRIC, BASE COAT 2, AND FINISH COAT COMPONENTS
4. BASE COAT – COMBINED COVERAGE (2 COATS) AT MINIMUM RATE AS DIRECTED IN THE SPECIFICATION.
5. EACH FINISH COAT SHALL BE APPLIED AT THE PRODUCT DATA SHEET RECOMMENDATIONS. ALLOW TO DRY BETWEEN COATS.
6. PRIMING – REFER TO TROPICAL ROOFING PRODUCTS SPECIFICATIONS FOR DECK PRIMING REQUIREMENTS

NOTE: NOTE: FOR SPECIFIC PRODUCT RECOMMENDATION REFER TO THE APPROPRIATE FLUID APPLIED SYSTEM GUIDE SPECIFICATIONS AT WWW.TROPICALROOFINGPRODUCTS.COM



FLUID APPLIED RESTORATION COATING SYSTEM
STANDARD STRUCTURAL CONCRETE ROOF DECK EDGE DETAIL
WITHOUT METAL DRIP EDGE

DATE :
12-13-16
 DETAIL NO :
3