

SECTION

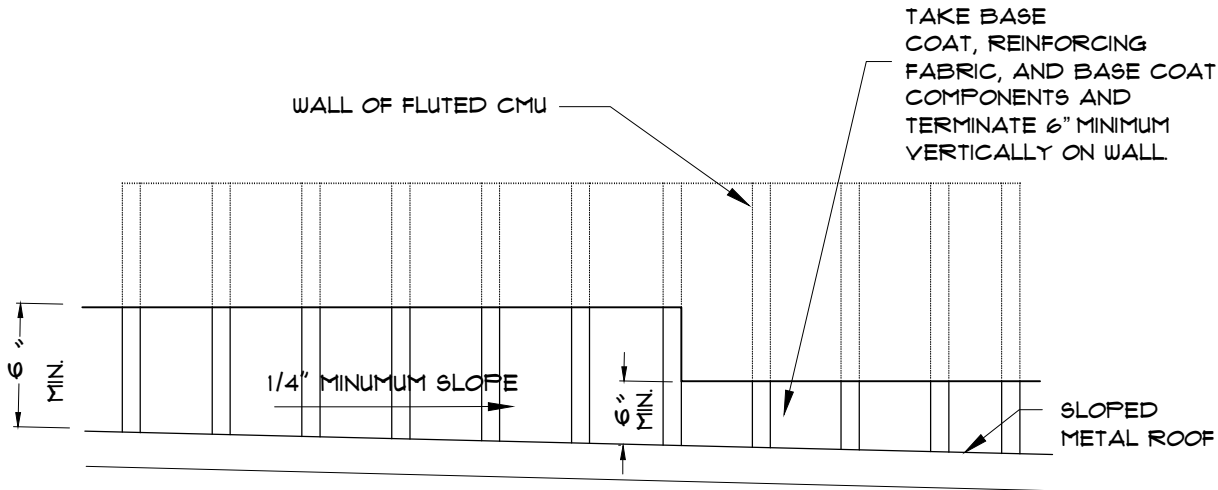

ELEVATION

NOTES:

1. ALL FLASHING SHALL BE DESIGNED FOR APPLICABLE CONDITIONS. METAL THICKNESS, FASTENERS, AND LAPPING SHALL BE AS SPECIFIED BY THE ROOF DESIGNER.
2. REFER TO THE SPECIFICATIONS FOR SPECIFIC EXECUTION REQUIREMENTS
3. FLUID APPLIED RESTORATION COATING SYSTEM - BASE COAT, REINFORCED FABRIC, BASE COAT 2, AND FINISH COAT COMPONENTS.
4. PRIMING - REFER TO TROPICAL ROOFING PRODUCTS SPECIFICATIONS FOR DECK PRIMING REQUIREMENTS.

NOTE: FOR SPECIFIC PRODUCT RECOMMENDATION REFER TO THE APPROPRIATE FLUID APPLIED SYSTEM GUIDE SPECIFICATIONS AT WWW.TROPICALROOFINGPRODUCTS.COM



FLUID APPLIED RESTORATION COATING SYSTEM

ROOF TO WALL DETAIL

DATE :
12-13-16

DETAIL NO :

31